

TECHICAL REIUREMENTS

- | | |
|---|------------------|
| 1. CANTILEVER STRENGTH: | 1250# [5.76KN] |
| 2. TENSILE STRENGTH: | 5000# [22.7KN] |
| 3. TORSION STRENGTH: | 6000"#[27.2KN.M] |
| 4. COMPRESSION STRENGTH: | 30000# [136KN] |
| 5. NEMA. VOLTAGE RATING: | 34.5KV |
| 6. 50 HERTZ WITHSTAND-DRY: | 80KV |
| 7. 50 HERTZ WITHSTAND-DEW: | 60KV |
| 8. IMPULSE WITHSTAND: | 150KV |
| 9. GLAZE: ANSI 70 LIGHT GREY | |
| 10. APPLICABLE STANDARD: ANSI C29.10-1989 | |

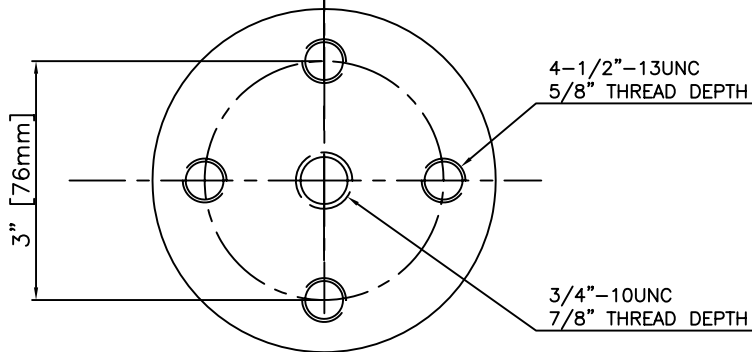

Medium Voltage Solutions

Eric, Pennsylvania, USA
 Tel: 814-520-6385
 Email: info@mvpower.us
 Web: www.mvpower.us

PART NO. A30-6
 INDOOR BUS SUPPORT